

# MINI AIR PRO

air cushion system

## User Manual

### Specification

Power : 220V/110V, 50Hz~60Hz  
Power consumption : 240W  
Speed : 25m/min  
Weight : 10Kg  
Colour : Blue  
Size : 375mmX340mmX390mm

### Accessories

Parts listed below included:



Allen keys



Teflon sticker



Power cord



Film extend holder  
(Install on machine before use)

### Machine Overview

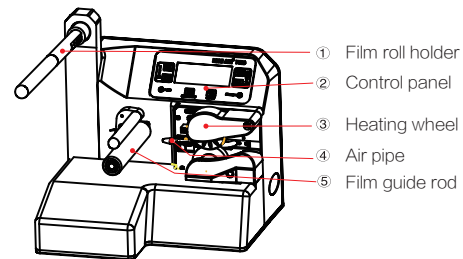

pic.1

- ① Film roll holder: Put the film roll on the holder to work on the machine.
- ② Control panel: Operation and change parameters.
- ③ Heating wheel: Heat and seal the air bags.
- ④ Air pipe: Inflate air into the film.
- ⑤ Film guide rod: Keep the tension on films during the film roll running.

### Adjust Air Volume

“+”: Increase  
“-”: Decrease  
Hold still can adjust faster.



### Adjust Temperature

“+”: Higher  
“-”: Lower  
Hold still can adjust faster.



### Select the type of film



Press the button “6” to switch film type.  
Solid circle highlights the current film type.  
Film width 20cm (8 inch) names Filler.  
Film width 40cm (16 inch) names Wrapper.

Better Cushion  
Better Protection

### Adjust speed

- Press still the button "3" for 3 seconds.
- Press "8" to increase, "7" to decrease.
- Press "6" to save and exit.

Speed:20

### Operation instruction

- Press down the knob above the heating roller before use.

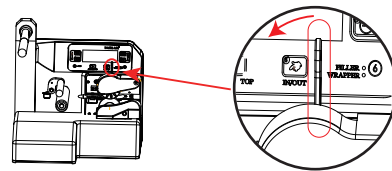

pic.2

- Load the film on to the film roll holder, air channel side should be load inside way, see next page for film guide with different sizes.

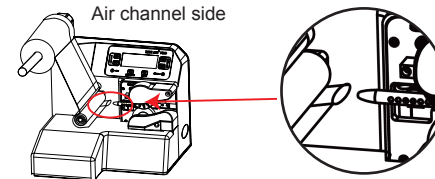

pic.3

- Sliding the film until get to the red roller, hold still IN/OUT button to get the film go through the machine.

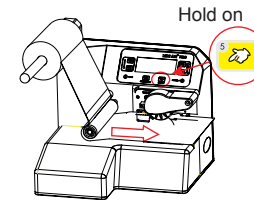

pic.4

### Control panel overview

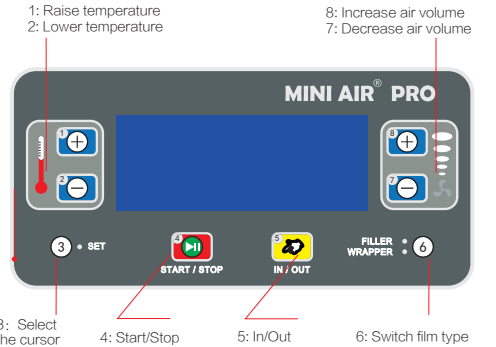

### Diagram for loading film roll

tube multi &  
tube small

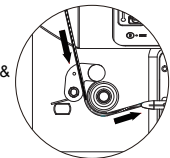

Filler &  
bubble &  
tube large

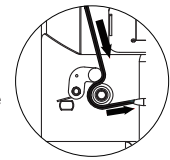

### Recommended parameter

For Material: HDPE Thickness:20µm

Wrapper	Speed	S.T	A.V
bubbles	20m/min	70	17
bubble wave	18m/min	68	20
tube multi	20m/min	70	17
tube wave	18m/min	68	20
tube small	15m/min	65	15
tube large	10m/min	60	12
Filler	Speed	S.T	A.V
200*100mm	25m/min	70	07
200*130mm	25m/min	70	09
200*150mm	25m/min	70	10
200*200mm	25m/min	70	13



Video for Operation and Maintenance



E-handbook